

DESCRIPTION: USB Type "A" RIGHT ANGLE THROUGH HOLE

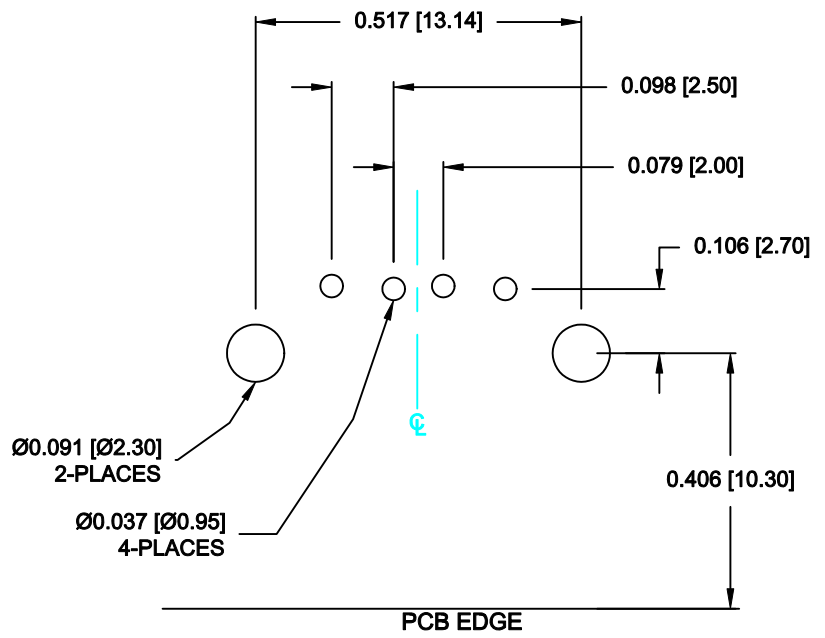
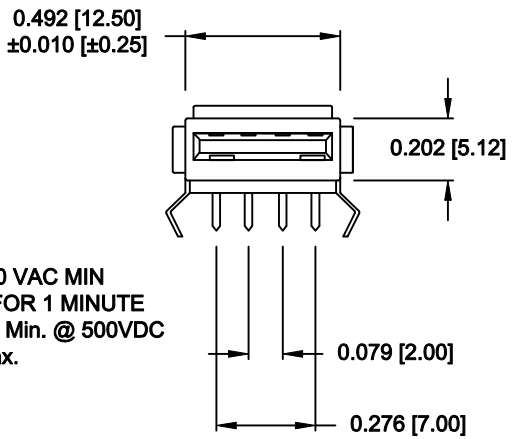
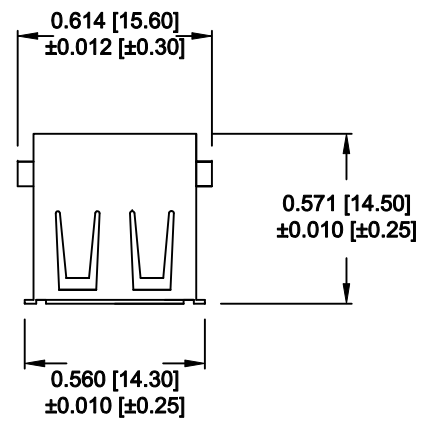
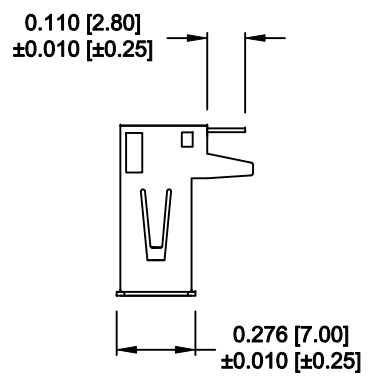

RECOMMENDED PCB LAYOUT

ELECTRICAL:

- CONTACT CURRENT RATING: 1.5 AMPS @ 250 VAC MIN
- DIELECTRIC WITHSTANDING VOLTAGE: 750 VAC (rms) FOR 1 MINUTE
- INSULATION RESISTANCE: 1,000 MegOhms Min. @ 500VDC
- CONTACT RESISTANCE: 30 MilliOhms Max.
- OPERATING TEMPERATURE: -55°C TO +85°C

MECHANICAL:

- MATING FORCE: 3.5 Kg Max. [35 N Max]
- UNMATING FORCE: 1.0 Kg Min. [10 N Min]
- DURABILITY: 1500 CYCLES

MATERIALS:

- CONTACTS: PHOSPHOR BRONZE
- INSULATOR: NYLON PA9T, WHITE
- SHELL: BRASS

PLATING:

- CONTACTS: GOLD FLASH (MATING AREA)
TIN (LEAD FREE) SOLDER TAILS
- SHELL: NICKEL PLATED
- USB VERSION: 2.0

DO NOT SCALE FROM DRAWING

	THESE DRAWINGS AND SPECIFICATIONS ARE THE PROPERTY OF NorComp AND SHALL NOT BE REPRODUCED, COPIED OR USED AS THE BASIS FOR THE MANUFACTURE OF SALE OF APPARATUS WITHOUT WRITTEN PERMISSION.		DRAWN: C. SMITH	DATE: 7-28-05
			CHECKED:	DATE:
<h1>NorComp</h1>		SCALE: NTS	SHEET 1 OF 1	REV 5
		DWG NO. 052-004-121R010		

RoHS COMPLIANT