

# 2345 Series

## FFC/FPC Connector 0.5mm(0.02") ZIF Type

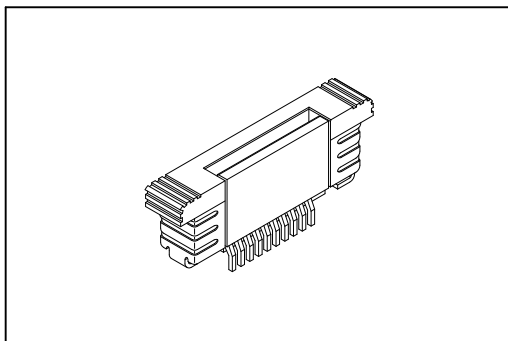

### Material:

Housing: High Temperature Plastic UL94V-0.

Contacts: Copper Alloy.

Solder Pad: Copper Alloy.

### Electrical Characteristics:

Current Rating: 0.4 A.

Dielectric Withstanding Voltage: AC 250V.

Insulator Resistance: 50MΩ min.

Contact Resistance: 30mΩ max.

Operating Temperature: -25°C~+85°C.

### Features:

\* ZIF, Surface Mount.

\* Size 4 through 50 available.

\* For 0.30mm(0.0118") thick FFC/FPC.

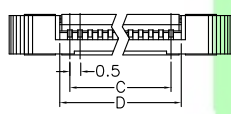
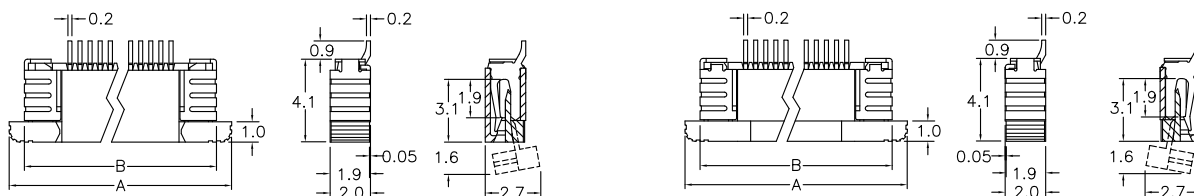

Top Contact

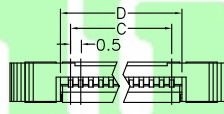

Bottom Contact

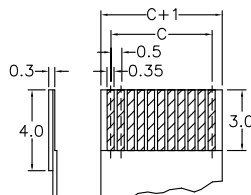
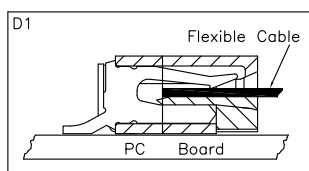

FFC/FPC Dimension

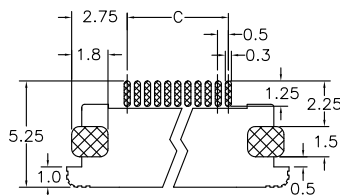
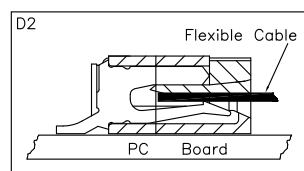

FFC/FPC Insert Direction  
P.C. Board Layout

Position	4 Thru 50
Dimension	
A	(No. of PositionsX0.5)+5.5
B	(No. of PositionsX0.5)+4.0
C	(No. of PositionsX0.5)-0.5
D	(No. of PositionsX0.5)+0.6

## Ordering Information

2345-

Series

50

No. of  
Pin Count

T

T: Tin Plated

D

D: SMD Type

1

1: Top Contact

2: Bottom Contact

T

T: Tape & Reel Package

U: Tube Package