

https://www.phoenixcontact.com/cn/products/0706524



Panel feed-through terminal block - DFK/DP-2,8-FRONT 2,5 - 0706524

Please be informed that the data shown in this PDF Document is generated from our Online Catalog. Please find the complete data in the user's documentation. Our General Terms of Use for Downloads are valid (<http://phoenixcontact.com/download>)



Panel feed-through terminal block, Connection method: Screw connection, Solder/Slip-on connection, Cross section: 0.2 mm² - 4 mm², AWG 24 - 12, Width: 6.2 mm, Color: gray

The illustration shows version DFK-2,8 FRONT 2,5



Key Commercial Data

Packing unit	50 STK
GTIN	 4 017918 003739
GTIN	4017918003739
Custom tariff number	8536909000
Sales Key	AABBDA

Technical data

General

Number of levels	1
Number of connections	2
Color	gray
Insulating material	PA
Flammability rating according to UL 94	V2
Rated surge voltage	4 kV
Degree of pollution	3
Overvoltage category	III
Insulating material group	I
Nominal current I _N	17.5 A
Nominal voltage U _N	400 V
Open side panel	No
Number of positions	0

Dimensions

<https://www.phoenixcontact.com/cn/products/0706524>



Panel feed-through terminal block - DFK/DP-2,8-FRONT 2,5 - 0706524

Technical data

Dimensions

Width	6.2 mm
-------	--------

Connection data

Connection side	Level 1 ext. 1
Connection method	Screw connection
Conductor cross section solid min.	0.2 mm ²
Conductor cross section solid max.	4 mm ²
Conductor cross section flexible min.	0.2 mm ²
Conductor cross section flexible max.	2.5 mm ²
Conductor cross section AWG min.	24
Conductor cross section AWG max.	12
Conductor cross section flexible, with ferrule without plastic sleeve min.	0.25 mm ²
Conductor cross section flexible, with ferrule without plastic sleeve max.	2.5 mm ²
Conductor cross section flexible, with ferrule with plastic sleeve min.	0.25 mm ²
Conductor cross section flexible, with ferrule with plastic sleeve max.	2.5 mm ²
2 conductors with same cross section, solid min.	0.2 mm ²
2 conductors with same cross section, solid max.	1 mm ²
2 conductors with same cross section, stranded min.	0.2 mm ²
2 conductors with same cross section, stranded max.	1.5 mm ²
2 conductors with same cross section, stranded, ferrules without plastic sleeve, min.	0.5 mm ²
2 conductors with same cross section, stranded, ferrules without plastic sleeve, max.	2.5 mm ²
Stripping length	14 mm
Internal cylindrical gage	A3
Screw thread	M3
Tightening torque, min	0.8 Nm
Tightening torque max	1 Nm
Connection side	Level 1 int. 1
Connection method	Solder/Slip-on connection
Conductor cross section solid min.	0.2 mm ²
Conductor cross section solid max.	1.5 mm ²
Conductor cross section flexible min.	0.2 mm ²
Conductor cross section flexible max.	1.5 mm ²
Conductor cross section AWG min.	24
Conductor cross section AWG max.	16
Internal cylindrical gage	A3
Slip-on connection	2.8 x 0.8 mm

Standards and Regulations

Connection in acc. with standard	CSA
	IEC / EN

Panel feed-through terminal block - DFK/DP-2,8-FRONT 2,5 - 0706524

Technical data

Standards and Regulations

Flammability rating according to UL 94	V2
--	----

Environmental Product Compliance

China RoHS	Environmentally friendly use period: unlimited = EFUP-e
	No hazardous substances above threshold values

Drawings

Dimensional drawing

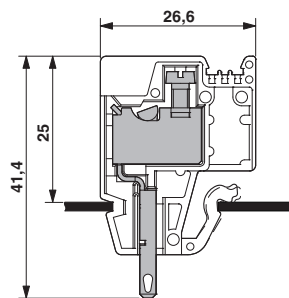

Approvals

Approvals

Approvals

CSA / UL Recognized / cUL Recognized / EAC / cULus Recognized

Ex Approvals

Approval details

CSA		http://www.csagroup.org/services/testing-and-certification/certified-product-listing/	13631
mm ² /AWG/kcmil	22-12		
Nominal current I _N	15 A		
Nominal voltage U _N	300 V		

<https://www.phoenixcontact.com/cn/products/0706524>



Panel feed-through terminal block - DFK/DP-2,8-FRONT 2,5 - 0706524

Approvals

UL Recognized		http://database.ul.com/cgi-bin/XYV/template/LISEXT/1FRAME/index.htm	FILE E 60425
mm ² /AWG/kcmil	28-12		
Nominal current IN	15 A		
Nominal voltage UN	300 V		

cUL Recognized		http://database.ul.com/cgi-bin/XYV/template/LISEXT/1FRAME/index.htm	FILE E 60425
mm ² /AWG/kcmil	28-12		
Nominal current IN	15 A		
Nominal voltage UN	300 V		

EAC		B.01742
-----	---	---------

cULus Recognized		http://database.ul.com/cgi-bin/XYV/template/LISEXT/1FRAME/index.htm
------------------	---	---