

https://www.phoenixcontact.com/cn/products/0708946



Panel feed-through terminal block - HDFKV 10-VP - 0708946

Please be informed that the data shown in this PDF Document is generated from our Online Catalog. Please find the complete data in the user's documentation. Our General Terms of Use for Downloads are valid (<http://phoenixcontact.com/download>)



Panel feed-through terminal block, Connection method: Screw connection, Solder connection, Load current : 76 A, Cross section: 0.5 mm² - 16 mm², AWG 20 - 6, Connection direction of the conductor to plug-in direction: 90 °, Width: 10.1 mm, Color: gray



Key Commercial Data

| | |
|----------------------|---|
| Packing unit | 50 STK |
| GTIN |  4 017918 004804 |
| GTIN | 4017918004804 |
| Custom tariff number | 8536909000 |
| Sales Key | AABDDA |

Technical data

General

| | |
|--|--|
| Number of levels | 1 |
| Number of connections | 2 |
| Nominal cross section | 10 mm ² |
| Color | gray |
| Insulating material | PA |
| Flammability rating according to UL 94 | V2 |
| Maximum load current | 76 A |
| Rated surge voltage | 6 kV |
| Degree of pollution | 3 |
| Overvoltage category | III |
| Insulating material group | I |
| Connection in acc. with standard | IEC 60947-7-1 |
| Nominal current I _N | 57 A |
| Maximum load current | 76 A |
| Nominal voltage U _N | 400 V (With metal panels of 1 mm ... 2.5 mm) |

<https://www.phoenixcontact.com/cn/products/0708946>



Panel feed-through terminal block - HDFKV 10-VP - 0708946

Technical data

General

| | |
|---------------------|--|
| | 250 V (With metal panels over 2.5 mm ... 4 mm) |
| | 500 V (With plastic panels of 1 mm ... 4 mm) |
| Open side panel | No |
| Number of positions | 1 |

Dimensions

| | |
|--------|---------|
| Width | 10.1 mm |
| Length | 49.8 mm |

Connection data

| | |
|---|---------------------|
| Connection side | Level 1 ext. 1 |
| Connection method | Screw connection |
| Conductor cross section solid min. | 0.5 mm ² |
| Conductor cross section solid max. | 16 mm ² |
| Conductor cross section flexible min. | 0.5 mm ² |
| Conductor cross section flexible max. | 10 mm ² |
| Conductor cross section AWG min. | 20 |
| Conductor cross section AWG max. | 6 |
| Conductor cross section flexible, with ferrule without plastic sleeve min. | 0.5 mm ² |
| Conductor cross section flexible, with ferrule without plastic sleeve max. | 10 mm ² |
| Conductor cross section flexible, with ferrule with plastic sleeve min. | 0.5 mm ² |
| Conductor cross section flexible, with ferrule with plastic sleeve max. | 10 mm ² |
| 2 conductors with same cross section, solid min. | 0.5 mm ² |
| 2 conductors with same cross section, solid max. | 4 mm ² |
| 2 conductors with same cross section, stranded min. | 0.5 mm ² |
| 2 conductors with same cross section, stranded max. | 4 mm ² |
| 2 conductors with same cross section, stranded, ferrules without plastic sleeve, min. | 0.5 mm ² |
| 2 conductors with same cross section, stranded, ferrules without plastic sleeve, max. | 2.5 mm ² |
| 2 conductors with same cross section, stranded, TWIN ferrules with plastic sleeve, min. | 0.5 mm ² |
| 2 conductors with same cross section, stranded, TWIN ferrules with plastic sleeve, max. | 6 mm ² |
| Cross section with insertion bridge, solid max. | 10 mm ² |
| Cross section with insertion bridge, stranded max. | 10 mm ² |
| Stripping length | 10 mm |
| Internal cylindrical gage | B6 |
| Screw thread | M4 |
| Tightening torque, min | 1.5 Nm |
| Tightening torque max | 1.8 Nm |
| Connection side | Inside |
| Connection method | Solder connection |



Panel feed-through terminal block - HDFKV 10-VP - 0708946

Technical data

Standards and Regulations

| | |
|--|---------------|
| Connection in acc. with standard | CSA |
| | IEC 60947-7-1 |
| Flammability rating according to UL 94 | V2 |

Environmental Product Compliance

| | |
|------------|---|
| China RoHS | Environmentally Friendly Use Period = 50 |
| | For details about hazardous substances go to tab "Downloads", Category "Manufacturer's declaration" |

Drawings

Dimensional drawing

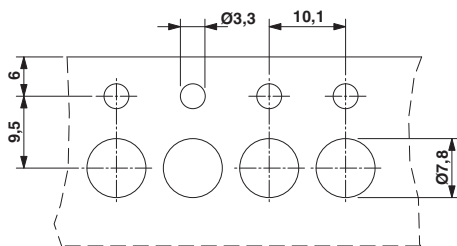

Dimensional drawing

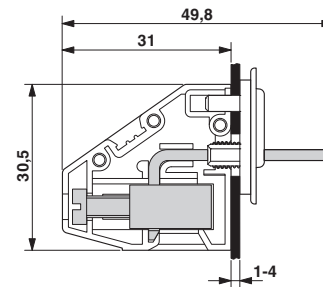

Panel feed-through

Side view

Approvals

Approvals

Approvals

CSA / KEMA-KEUR / PRS / IECCE CB Scheme / cULus Recognized / EAC

Ex Approvals

Approval details

| | | | |
|--------------------------------|---|---|-------|
| CSA |  | http://www.csagroup.org/services/testing-and-certification/certified-product-listing/ | 13631 |
| mm ² /AWG/kcmil | | 22-6 | |
| Nominal current I _N | | 65 A | |
| Nominal voltage U _N | | 300 V | |

<https://www.phoenixcontact.com/cn/products/0708946>





Panel feed-through terminal block - HDFKV 10-VP - 0708946

Approvals

| | | | |
|----------------------------|---|---|------------|
| KEMA-KEUR |  | http://www.dekra-certification.com | 2169260.01 |
| mm ² /AWG/kcmil | | 10 | |
| Nominal current IN | | 57 A | |
| Nominal voltage UN | | 250 V | |

| | | | |
|-----|---|---|-------------------|
| PRS |  | http://www.prs.pl/ | TE/1825/880590/09 |
|-----|---|---|-------------------|

| | | | |
|----------------------------|---|---|----------|
| IECEE CB Scheme |  | http://www.iecee.org/ | NL-29947 |
| mm ² /AWG/kcmil | | 10 | |
| Nominal current IN | | 57 A | |
| Nominal voltage UN | | 250 V | |

| | | | |
|----------------------------|---|---|-----------------|
| cULus Recognized |  | http://database.ul.com/cgi-bin/XYV/template/LISEXT/1FRAME/index.htm | E60425-19870911 |
| | B | D | |
| mm ² /AWG/kcmil | 24-6 | 24-6 | |
| Nominal current IN | 65 A | 10 A | |
| Nominal voltage UN | 300 V | 300 V | |

| | | |
|-----|---|---------|
| EAC |  | B.01742 |
|-----|---|---------|

Phoenix Contact 2017 © - all rights reserved
<http://www.phoenixcontact.com>