

https://www.phoenixcontact.com/cn/products/1790364



PCB terminal block - FFKDSA/V1-7,62 - 1790364

Please be informed that the data shown in this PDF Document is generated from our Online Catalog. Please find the complete data in the user's documentation. Our General Terms of Use for Downloads are valid (<http://phoenixcontact.com/download>)



PCB terminal block, Nominal current: 17.5 A, Nom. voltage: 630 V, Pitch: 7.62 mm, Number of positions: 1, Connection method: Push-in spring connection, Mounting: Wave soldering, Conductor/PCB connection direction: 90°, Color: green, The article can be aligned to create different nos. of positions!

Why buy this product

- ✓ Time saving push-in connection, tools not required
- ✓ Defined contact force ensures that contact remains stable over the long term
- ✓ Intuitive use through colour coded actuation lever
- ✓ Operation and conductor connection from one direction enable integration into front of device
- ✓ Two solder pins reduce the mechanical strain on the soldering spots
- ✓ The latching on the side enables various numbers of positions to be combined
- ✓ Vertical connection enables multi-row arrangement on the PCB

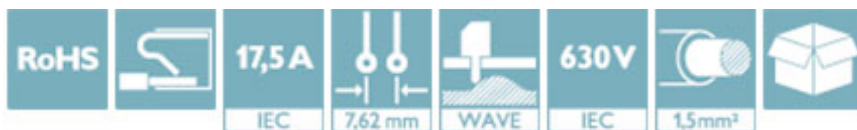

Key Commercial Data

| | |
|----------------------|---|
| Packing unit | 250 STK |
| GTIN |  4 017918 044275 |
| GTIN | 4017918044275 |
| Custom tariff number | 8536909000 |
| Sales Key | AAABFA |

Technical data

Dimensions

| | |
|--------------------------|------------|
| Length | 12.7 mm |
| Pitch | 7.62 mm |
| Dimension a | 7.62 mm |
| Constructional height | 17 mm |
| Height | 13.6 mm |
| Length of the solder pin | 3.4 mm |
| Pin dimensions | 0,5 x 1 mm |

https://www.phoenixcontact.com/cn/products/1790364



PCB terminal block - FFKDSA/V1-7,62 - 1790364

Technical data

Dimensions

| | |
|---------------|--------|
| Hole diameter | 1.3 mm |
|---------------|--------|

General

| | |
|--|---|
| Range of articles | FFKDS(A)/V1 |
| Insulating material group | I |
| Rated surge voltage (III/3) | 6 kV |
| Rated surge voltage (III/2) | 6 kV |
| Rated surge voltage (II/2) | 6 kV |
| Rated voltage (III/3) | 500 V |
| Rated voltage (III/2) | 630 V |
| Rated voltage (II/2) | 1000 V |
| Connection in acc. with standard | EN-VDE |
| Nominal current I_N | 17.5 A |
| Nominal cross section | 1.5 mm ² |
| Maximum load current | 17.5 A (with 1.5 mm ² conductor cross section) |
| Insulating material | PA |
| Solder pin surface | Sn |
| Flammability rating according to UL 94 | V0 |
| Stripping length | 10 mm |
| Number of positions | 1 |

Connection data

| | |
|--|----------------------|
| Conductor cross section solid min. | 0.2 mm ² |
| Conductor cross section solid max. | 1.5 mm ² |
| Conductor cross section flexible min. | 0.2 mm ² |
| Conductor cross section flexible max. | 1.5 mm ² |
| Conductor cross section flexible, with ferrule without plastic sleeve min. | 0.25 mm ² |
| Conductor cross section flexible, with ferrule without plastic sleeve max. | 0.75 mm ² |
| Conductor cross section flexible, with ferrule with plastic sleeve min. | 0.25 mm ² |
| Conductor cross section flexible, with ferrule with plastic sleeve max. | 0.75 mm ² |
| Conductor cross section AWG min. | 24 |
| Conductor cross section AWG max. | 16 |

Standards and Regulations

| | |
|--|--------|
| Connection in acc. with standard | EN-VDE |
| | CSA |
| Flammability rating according to UL 94 | V0 |

Environmental Product Compliance

| | |
|------------|---|
| China RoHS | Environmentally friendly use period: unlimited = EFUP-e |
| | No hazardous substances above threshold values |

Drawings

https://www.phoenixcontact.com/cn/products/1790364



PCB terminal block - FFKDSA/V1-7,62 - 1790364

Dimensional drawing

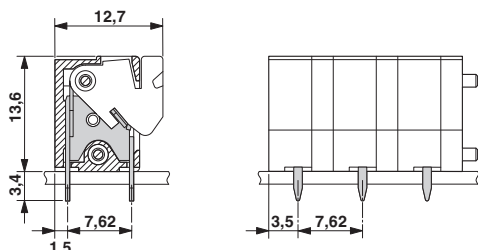

Drilling diagram

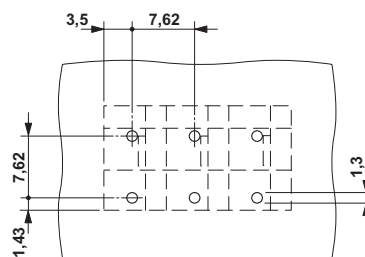

Approvals

Approvals

Approvals

CSA / UL Recognized / KEMA-KEUR / cUL Recognized / CCA / IECCE CB Scheme / EAC / cULus Recognized

Ex Approvals

Approval details

| | | | |
|--------------------------------|-------|---|-------|
| CSA | | http://www.csagroup.org/services/testing-and-certification/certified-product-listing/ | 13631 |
| | B | D | |
| mm ² /AWG/kcmil | 16 | 16 | |
| Nominal current I _N | 10 A | 10 A | |
| Nominal voltage U _N | 300 V | 300 V | |

| | | | |
|--------------------------------|-------|---|--------------|
| UL Recognized | | http://database.ul.com/cgi-bin/XYV/template/LISEXT/1FRAME/index.htm | FILE E 60425 |
| | B | D | |
| mm ² /AWG/kcmil | 22-16 | 22-16 | |
| Nominal current I _N | 10 A | 10 A | |
| Nominal voltage U _N | 300 V | 300 V | |

| | | | |
|----------------------------|-----|---|------------|
| KEMA-KEUR | | http://www.dekra-certification.com | 2160724.01 |
| mm ² /AWG/kcmil | 1.5 | | |

<https://www.phoenixcontact.com/cn/products/1790364>



PCB terminal block - FFKDSA/V1-7,62 - 1790364

Approvals

| | |
|--------------------|-------|
| Nominal voltage UN | 500 V |
|--------------------|-------|

| | | | |
|----------------------------|---|---|--------------|
| cUL Recognized |  | http://database.ul.com/cgi-bin/XYV/template/LISEXT/1FRAME/index.htm | FILE E 60425 |
| | B | D | |
| mm ² /AWG/kcmil | 22-16 | 22-16 | |
| Nominal current IN | 10 A | 10 A | |
| Nominal voltage UN | 300 V | 300 V | |

| | | | |
|----------------------------|-------------|--|--|
| CCA | NTR NL-7074 | | |
| mm ² /AWG/kcmil | 1.5 | | |
| Nominal voltage UN | 500 V | | |

| | | | |
|----------------------------|---|---|----------|
| IECEE CB Scheme |  | http://www.iecee.org/ | NL-25836 |
| mm ² /AWG/kcmil | 1.5 | | |
| Nominal voltage UN | 500 V | | |

| | | |
|-----|---|---------|
| EAC |  | B.01742 |
|-----|---|---------|

| | | |
|------------------|---|---|
| cULus Recognized |  | http://database.ul.com/cgi-bin/XYV/template/LISEXT/1FRAME/index.htm |
|------------------|---|---|

Phoenix Contact 2017 © - all rights reserved
<http://www.phoenixcontact.com>