

https://www.phoenixcontact.com/cn/products/1841856



PCB terminal block - MKDSP 95/ 1-20,0-FL - 1841856

Please be informed that the data shown in this PDF Document is generated from our Online Catalog. Please find the complete data in the user's documentation. Our General Terms of Use for Downloads are valid (<http://phoenixcontact.com/download>)



PCB terminal block, Nominal current: 232 A, Nom. voltage: 1000 V, Pitch: 20 mm, Number of positions: 1, Connection method: Screw connection with tension sleeve, Mounting: Wave soldering, Conductor/PCB connection direction: 0°, Color: green

Why buy this product

- Well-known connection principle allows worldwide use
- Low temperature rise, thanks to maximum contact force
- Allows connection of two conductors
- Quick and convenient testing using integrated test option
- Integrated protective guide prevents incorrect insertion of the conductor underneath the tension sleeve



Key Commercial Data

| | |
|------------------------|---|
| Packing unit | 5 STK |
| Minimum order quantity | 5 STK |
| GTIN |  4 046356 920018 |
| GTIN | 4046356920018 |
| Sales Key | AABJDA |

Technical data

Dimensions

| | |
|--------------------------|----------|
| Length | 44 mm |
| Pitch | 20 mm |
| Width | 52 mm |
| Constructional height | 69 mm |
| Height | 73 mm |
| Length of the solder pin | 4 mm |
| Pin dimensions | 3 x 3 mm |
| Pin spacing | 13.8 mm |
| Hole diameter | 4.8 mm |

<https://www.phoenixcontact.com/cn/products/1841856>

PCB terminal block - MKDSP 95/ 1-20,0-FL - 1841856

Technical data

General

| | |
|--|--------------------|
| Range of articles | MKDSP 95/...-FL |
| Insulating material group | I |
| Rated surge voltage (III/3) | 8 kV |
| Rated surge voltage (III/2) | 8 kV |
| Rated surge voltage (II/2) | 6 kV |
| Rated voltage (III/3) | 1000 V |
| Rated voltage (III/2) | 1000 V |
| Rated voltage (II/2) | 1000 V |
| Connection in acc. with standard | EN-VDE |
| Nominal current I_N | 232 A |
| Nominal cross section | 95 mm ² |
| Maximum load current | 232 A |
| Insulating material | PA |
| Solder pin surface | Sn |
| Flammability rating according to UL 94 | V0 |
| Stripping length | 25 mm |
| Number of positions | 1 |
| Screw thread | M8 |
| Tightening torque, min | 10 Nm |

Connection data

| | |
|---|--------------------|
| Conductor cross section solid min. | 10 mm ² |
| Conductor cross section solid max. | 16 mm ² |
| Conductor cross section flexible min. | 25 mm ² |
| Conductor cross section flexible max. | 95 mm ² |
| Conductor cross section flexible, with ferrule without plastic sleeve min. | 16 mm ² |
| Conductor cross section flexible, with ferrule without plastic sleeve max. | 95 mm ² |
| Conductor cross section flexible, with ferrule with plastic sleeve min. | 16 mm ² |
| Conductor cross section flexible, with ferrule with plastic sleeve max. | 95 mm ² |
| Conductor cross section AWG min. | 6 |
| Conductor cross section AWG max. | 3/0 |
| 2 conductors with same cross section, solid min. | 16 mm ² |
| 2 conductors with same cross section, solid max. | 25 mm ² |
| 2 conductors with same cross section, stranded min. | 16 mm ² |
| 2 conductors with same cross section, stranded max. | 25 mm ² |
| 2 conductors with same cross section, stranded, ferrules without plastic sleeve, min. | 16 mm ² |
| 2 conductors with same cross section, stranded, ferrules without plastic sleeve, max. | 25 mm ² |
| 2 conductors with same cross section, stranded, TWIN ferrules with plastic sleeve, min. | 16 mm ² |

https://www.phoenixcontact.com/cn/products/1841856



PCB terminal block - MKDSP 95/ 1-20,0-FL - 1841856

Technical data

Connection data

| | |
|---|--------------------|
| 2 conductors with same cross section, stranded, TWIN ferrules with plastic sleeve, max. | 25 mm ² |
|---|--------------------|

Standards and Regulations

| | |
|--|--------|
| Connection in acc. with standard | EN-VDE |
| Flammability rating according to UL 94 | V0 |

Environmental Product Compliance

| | |
|------------|---|
| China RoHS | Environmentally friendly use period: unlimited = EFUP-e |
| | No hazardous substances above threshold values |

Drawings

Drilling diagram

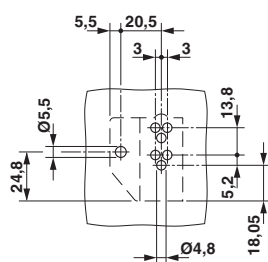

Dimensional drawing

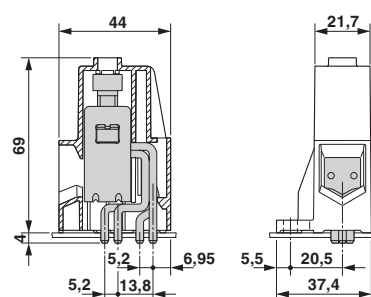

Diagram

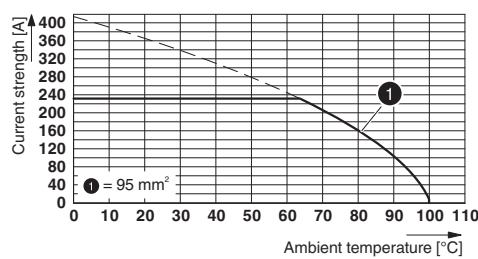

Type: MKDSP 95/ 4-20,0-F

Tested in accordance with DIN EN 60512-5-2:2003-01

Reduction factor = 1

Number of positions: 4

Approvals

Approvals

Approvals

VDE Zeichengenehmigung / IECCE CB Scheme / EAC / cULus Recognized

<https://www.phoenixcontact.com/cn/products/1841856>





PCB terminal block - MKDSP 95/ 1-20,0-FL - 1841856

Approvals

Ex Approvals

Approval details

| | | | |
|----------------------------|---|---|----------|
| VDE Zeichengenehmigung |  | http://www.vde.com/en/Institute/OnlineService/VDE-approved-products/Pages/Online-Search.aspx | 40041859 |
| mm ² /AWG/kcmil | 10-95 | | |
| Nominal current IN | 232 A | | |
| Nominal voltage UN | 1000 V | | |

| | | | |
|----------------------------|---|---|--------------|
| IECEE CB Scheme |  | http://www.iecee.org/ | DE1-55351-B1 |
| mm ² /AWG/kcmil | 10-95 | | |
| Nominal current IN | 232 A | | |
| Nominal voltage UN | 1000 V | | |

| | | |
|-----|---|---------|
| EAC |  | B.01742 |
|-----|---|---------|

| | | | |
|----------------------------|---|---|-----------------|
| cULus Recognized |  | http://database.ul.com/cgi-bin/XYV/template/LISEXT/1FRAME/index.htm | E60425-19770427 |
| | B | C | |
| mm ² /AWG/kcmil | 6-3/0 | 6-3/0 | |
| Nominal current IN | 200 A | 200 A | |
| Nominal voltage UN | 600 V | 600 V | |

Phoenix Contact 2017 © - all rights reserved
<http://www.phoenixcontact.com>