

https://www.phoenixcontact.com/cn/products/1841899



## Printed-circuit board connector - PSC 1,5/ 5-M - 1841899

Please be informed that the data shown in this PDF Document is generated from our Online Catalog. Please find the complete data in the user's documentation. Our General Terms of Use for Downloads are valid (<http://phoenixcontact.com/download>)

Header, Nominal current: 8 A, Number of positions: 5, Pitch: 3.5 mm, Color: green, Contact surface: Tin, Mounting: Wave soldering



The figure shows a 5-pos. version of the product

### Why buy this product

- Well-known connection principle allows worldwide use
- Shroud for professional EMC shield feed-through on the inside of the device
- Screwable flange for superior mechanical stability

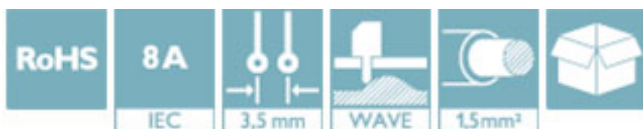

### Key Commercial Data

Packing unit	50 STK
GTIN	 4 017918 111878
GTIN	4017918111878
Custom tariff number	8536901900
Sales Key	AAAECA

### Technical data

#### Dimensions

Length	20.8 mm
Pitch	3.5 mm
Dimension a	14 mm
Constructional height	14 mm
Length of the solder pin	3.5 mm

#### General

Range of articles	PSC 1,5/..-M
Insulating material group	I
Rated voltage (III/3)	250 V

# Printed-circuit board connector - PSC 1,5/ 5-M - 1841899

## Technical data

### General

Connection in acc. with standard	EN-VDE
Nominal current $I_N$	8 A
Insulating material	PA
Flammability rating according to UL 94	V0
Color	green
Number of positions	5

### Standards and Regulations

Connection in acc. with standard	EN-VDE
	CSA
Flammability rating according to UL 94	V0

### Environmental Product Compliance

China RoHS	Environmentally friendly use period: unlimited = EFUP-e
	No hazardous substances above threshold values

## Drawings

Drilling diagram

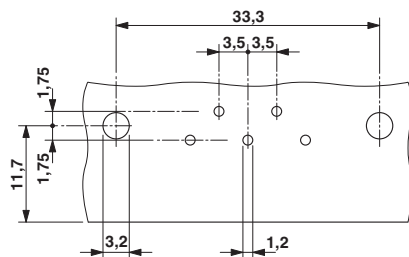

Dimensional drawing

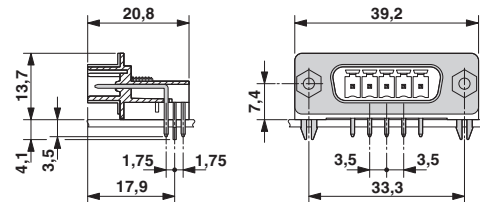

Dimensional drawing

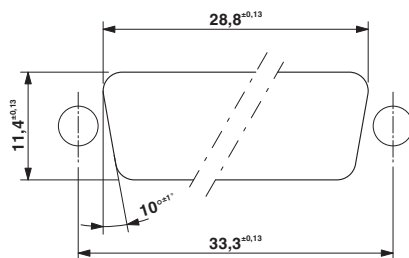

Dimensional drawing

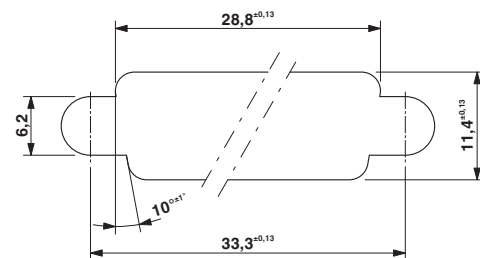

Panel cutout in acc. with DIN 41652-3 for wall up to 2.0 mm thick

Panel cutout in acc. with DIN 41652-3 for walls up to 4.5 mm thick

## Approvals

### Approvals

<https://www.phoenixcontact.com/cn/products/1841899>



## Printed-circuit board connector - PSC 1,5/ 5-M - 1841899

### Approvals

Approvals

CSA / cULus Recognized / EAC

Ex Approvals

### Approval details

CSA		<a href="http://www.csagroup.org/services/testing-and-certification/certified-product-listing/">http://www.csagroup.org/services/testing-and-certification/certified-product-listing/</a>	13631
		B	D
Nominal current I <sub>N</sub>		8 A	8 A
Nominal voltage U <sub>N</sub>		300 V	300 V

cULus Recognized		<a href="http://database.ul.com/cgi-bin/XYV/template/LISEXT/1FRAME/index.htm">http://database.ul.com/cgi-bin/XYV/template/LISEXT/1FRAME/index.htm</a>	E60425-19920306
		B	D
Nominal current I <sub>N</sub>		8 A	8 A
Nominal voltage U <sub>N</sub>		300 V	300 V

EAC			B.01742
-----	---	--	---------

Phoenix Contact 2017 © - all rights reserved  
<http://www.phoenixcontact.com>