

HSF

NOTES:

Current Rating:0.5A
 Voltage Rating:50V AC/DC
 Contact Resistance:50milliohm Max
 Insulation Resistance:100Megohm Min
 Operation Temperature:-20°Cto+105°C

Housing Material:PA9T(UL94V-0)
 Cap Material:LCP(UL94V-0)
 Contact Material:Phosphor Bronze
 Contact plating:Au or Sn over Ni

Recommended P.C.B Layout (Top Side)
 (PCB BOARD TOLERANCE ± 0.05)

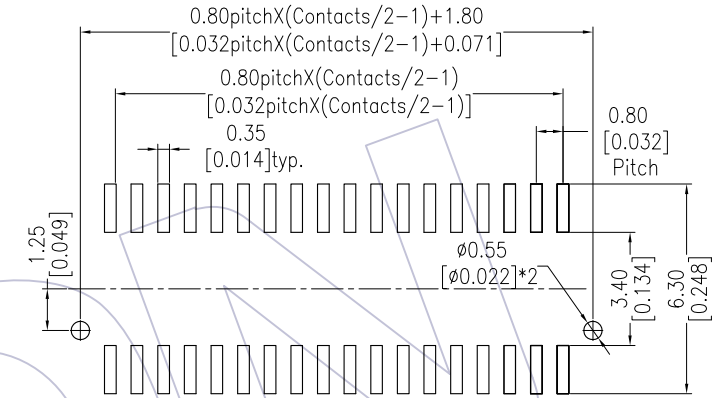
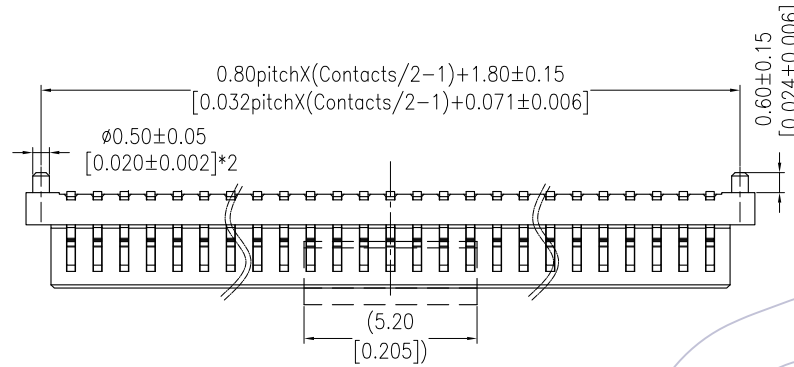

Ordering Information

3610-P XXX - XXX XX R 01

No.of Pins Housing High Contact Plating
 T=Tube P=Tube+CAP
 R=Tape&Reel+CAP

ASS'Y HIGH(H)	PLUG(H1)	SOCKET(H2)
4.00	1.00	3.00
4.50	1.50	3.00
5.00	2.00	3.00
5.50	1.50	4.00
6.00	2.00	4.00
6.50	2.00	4.50
7.00	3.00	4.00
7.50	3.00	4.50
8.00	4.00	4.00

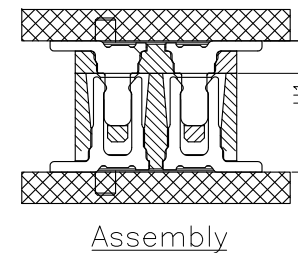
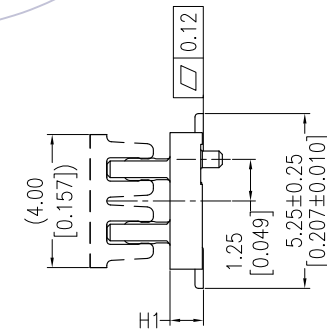
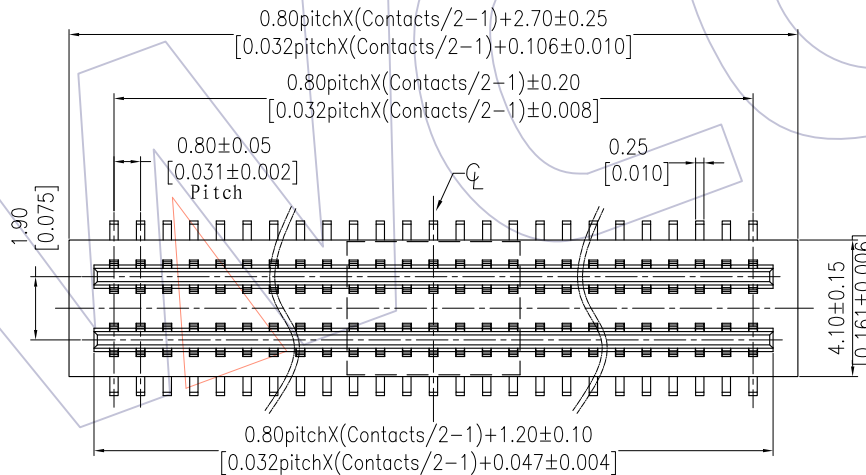

REV	DATE	MODIFICATION DESCRIPTION	CHANGE	OPERATION		DRAW	DATE	SCALE	FIT	PART NO.
				Angle	DIM TOL					
A0	2012/11/02	NEW		X.X	±0.40		2012/11/02		mm	3610-PXXX-XXXXXR01
				X.XX	±0.25	CHECK		inch		
				X.XXX	±0.15	APPROVE		A4		TITLE:
								1/1		0.80mm B TO B
								PROJ.		MALE 180° SMT TYPE