

HSF

NOTES:

Current Rating: 2.0AMP
Contact Resistance: 20mΩ Max
Withstand Voltage: 500V AC/DC
Insulation Resistance: 1000MΩ Min
Operation Temperature: -40℃ to +105℃

Contact Material: Phosphor Bronze
Contact plating: Au Or Sn over Ni
Insulator Material: PA9T+30%G.F UL94V-0

Ordering Information

2243-1 XX M XX CUN T X

No. of Pins per
Row: 02~40Pin

Contact Plating:
G0=Gold Flash
G3=10μ"Gold
G4=15μ"Gold
G5=30μ"Gold
S0=Gold Flash/Tin
S3=10μ"Gold/Tin
S4=15μ"Gold/Tin
S5=30μ"Gold/Tin
SN=Tin
SM=Matte Tin

Packing:
T=Tube
P=Tube+CAP
R=Tape&Reel+CAP

Series No.
1=Type 1
2=Type 2

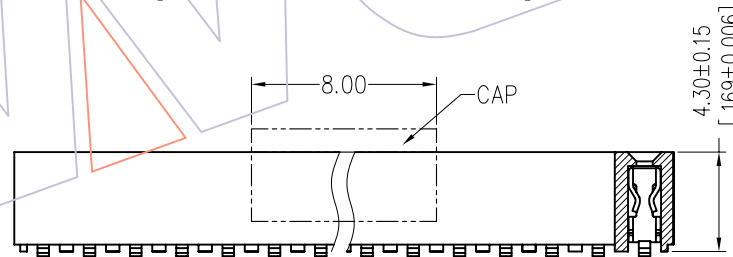
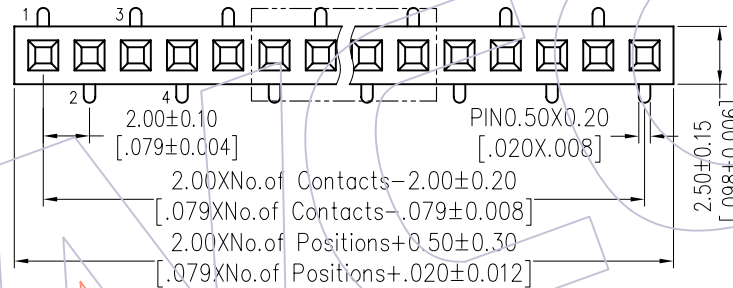
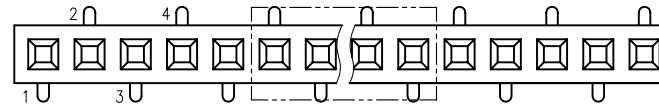

Recommended P.C.B Layout(Top Side)
(PCB BOARD TOLERANCE±0.05)

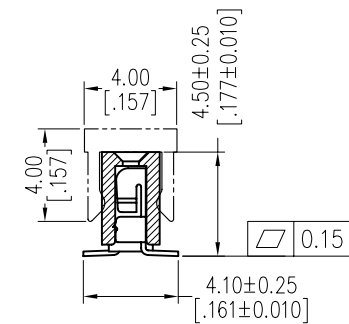
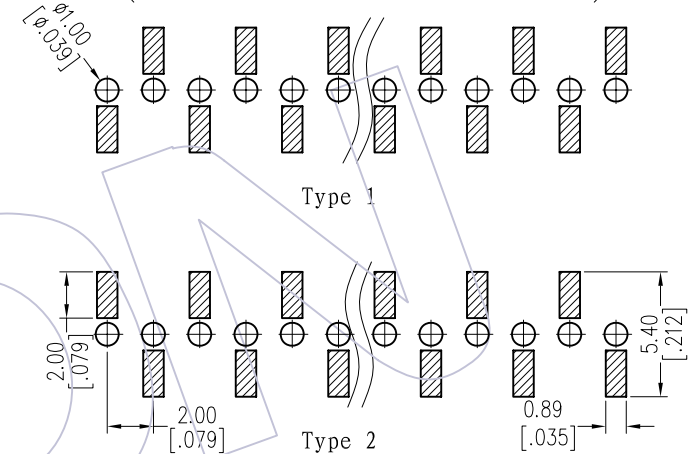

Item	Pitch	Mating
Standard	2.00	1215/1220
Alternate		

TITLE	PART NO.
TYPE 1	2243-1XXMXXCUNT1
TYPE 2	2243-1XXMXXCUNT2

REV		DATE	MODIFICATION DESCRIPTION	CHANGE	OPERATION	DRAW	DATE	SCALE	FIT	PART NO.
A0		2012/07/13	NEW	-----	x.x ±0.40	JYHuang	2012/07/13	UNIT	mm	SEE TABLE
					x.xx ±0.25	CHECK	DATE	SIZE	A4	TITLE:
					x.xxx ±0.15	APPROVE	DATE	SHEET	1/1	FH2.00 SINGLE ROW 180° SMT H=4.3
					Angle ± 3'			PROJ.	Customer NO.	
					DIM TOL					