

HSF

NOTES:

Current Rating::3.0A AMP
 Withstand Voltage:250V AC/minute
 Contact Resistance:30mΩ Max
 Withstand Voltage:1000V AC/Minute
 Insulation Resistance:1000MΩ Min
 Operation Temperature:-25°Cto+85°C

Contact Material:Brass
 Contact plating:Au or Sn Over Ni
 Insulator Material:Polyester(UL94V-0)
 Standard:PA6T+30%G.F

RECOMMENDED PCB LAYOUT
 TOLERANCE IS ±0.05

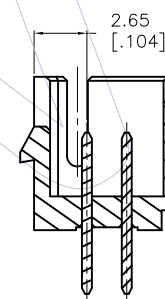
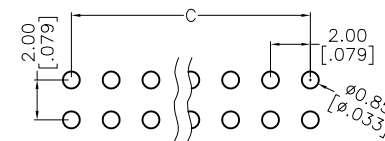
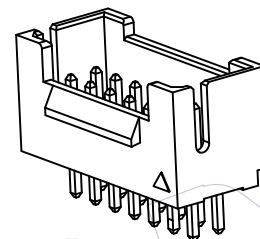
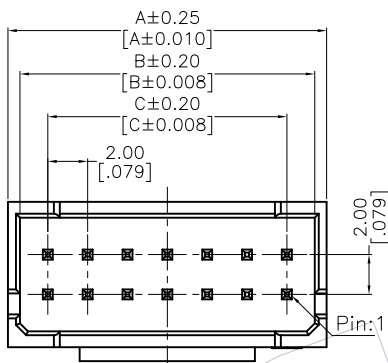

Ordering Information

WF2005-2WS XX E X 1

No. of Pins: 14P~40P
 Insulator Color: E= Beige
 Packing: T=Tube, 0=PE Bag

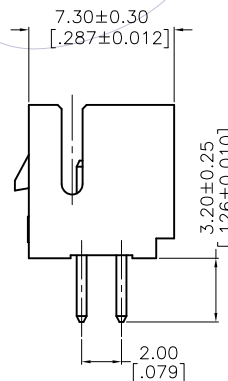
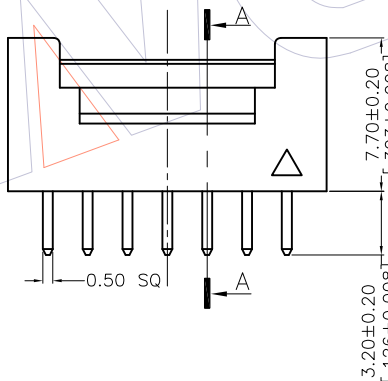

Circuits	Part NO.	Dimensions		
		A	B	C
2X07	WF2005-2WS07EX1	16.00[0.630]	14.80[0.583]	12.00[0.472]
2X08	WF2005-2WS08EX1	18.00[0.709]	16.80[0.661]	14.00[0.551]
2X09	WF2005-2WS09EX1	20.00[0.787]	18.80[0.740]	16.00[0.630]
2X10	WF2005-2WS10EX1	22.00[0.866]	20.80[0.819]	18.00[0.709]
2X11	WF2005-2WS11EX1	24.00[0.945]	22.80[0.898]	20.00[0.787]
2X12	WF2005-2WS12EX1	26.00[1.024]	24.80[0.976]	22.00[0.866]
2X13	WF2005-2WS13EX1	28.00[1.102]	26.80[1.055]	24.00[0.945]
2X14	WF2005-2WS14EX1	30.00[1.181]	28.80[1.134]	26.00[1.024]
2X15	WF2005-2WS15EX1	32.00[1.260]	30.80[1.213]	28.00[1.102]
2X16	WF2005-2WS16EX1	34.00[1.339]	32.80[1.291]	30.00[1.181]
2X17	WF2005-2WS17EX1	36.00[1.418]	34.80[1.370]	32.00[1.260]
2X18	WF2005-2WS18EX1	38.00[1.496]	36.80[1.449]	34.00[1.339]
2X19	WF2005-2WS19EX1	40.00[1.575]	38.80[1.528]	36.00[1.418]
2X20	WF2005-2WS20EX1	42.00[1.654]	40.80[1.606]	38.00[1.496]

				OPERATION		DRAW		DATE		SCALE		PART NO.		
				X.X	±0.40	Sam		2013.06.08		1:1		WF2005-2WSXXEX1		
				X.XX	±0.25	CHECK		DATE		mm		TITLE:		
				X.XXX	±0.15	APPROVE		DATE		inch		2.00mm PH WTB WAFER 180° DIP		
A0	2013.06.08	NEW		Angle						1/1		Customer NO.		
REV	DATE	MODIFICATION DESCRIPTION		CHANGE	DIM	TOL								