

# HSF

## TECHNICAL SPECS:

Current Rating:3.0AMP  
 Contact Resistance:10mΩ Max  
 Dielectric Strength: Min 1000VRMS  
 Mechanical Life: Min 500 cycles  
 Mating Pin:∅0.40 to ∅0.66mm or 0.50SQ  
 Forces: (polished steel gauge ∅0.47mm)  
 Insertion:200g Max/Pin, Withdrawal:60g/Pin  
 Operation Temperature:-40°C to +105°C

Sleeve:Brass CuZn36Pb3(C36000),Sn over Ni  
 Contact Clip(4 finger):BeCu(C17200),Au or Sn over Ni  
 Insulator Material:PPS+30%G.F(UL94V-0)

## Ordering Information

3522-282 XX M XX 074 X 1

No. of Pin 2-40PIN	Contact Plating S0=Gold Flash/Tin S3=10u"Gold/Tin S4=15u"Gold/Tin S5=30u"Gold/Tin SN=Tin	Packing T=Tube R=Tape&Reel
-----------------------	---	----------------------------------

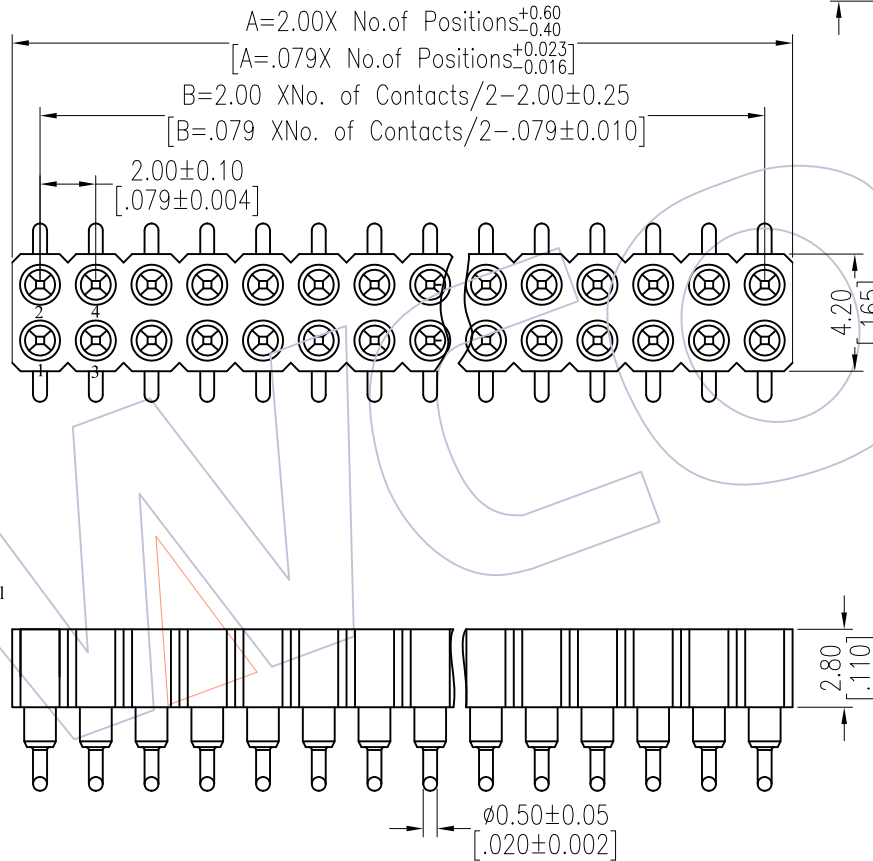

## Recommended P.C.B Layout(Top Side) (PCB BOARD TOLERANCE ±0.05)

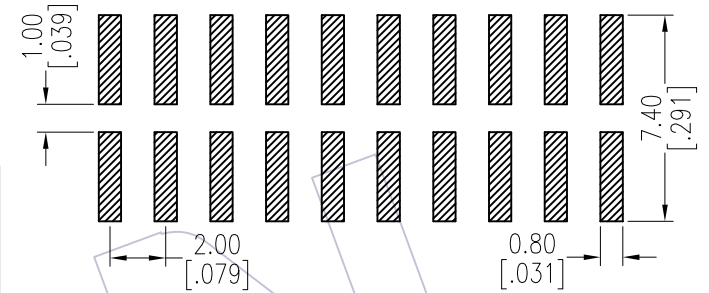

NO. of PIN	DIM A
40PIN	$2.0 \times \text{NO. of Positions} + 1.00 \pm 0.40$
<40PIN	$2.0 \times \text{NO. of Positions} \begin{matrix} +0.60 \\ -0.40 \end{matrix}$

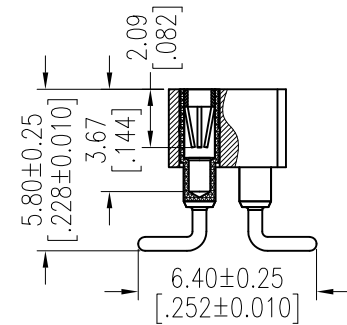

Item	Pitch	Mating
Standard	2.00	3512
Alternate		

REV	DATE	MODIFICATION DESCRIPTION	CHANGE	OPERATION		DRAW Wang	DATE 2013/05/17	SCALE UNIT	FIT mm	PART NO. 3522-282XXMXX074X1
				X.X	±0.40					
A1	2013/05/17	Modify drawing	-----	X.XX	±0.25	CHECK	DATE	SIZE	A4	TITLE: 2.00mm MACHINED FEMALE HEADER DUAL ROW SMT H=2.80 L=7.4
A0	2012/10/17	NEW	-----	X.XXX	±0.15	APPROVE	DATE	SHEET	1/1	Customer NO.
				Angle	± 3'			PROJ.		
				DIM	TOL					