

HSF

TECHNICAL SPECS:

Current Rating:3.0AMP
 Contact Resistance:10mΩ Max
 Dielectric Strength: Min 1000Vrms
 Mechanical Life: Min 500 cycles
 Mating Pin:Ø0.40 to Ø0.66mm or 0.50SQ
 Forces: (polished steel gauge Ø0.47mm)
 Insertion:200g Max/Pin, Withdrawal:60g/Pin
 Operation Temperature:-40°C to +105°C

Sleeve:Brass CuZn36Pb3(C36000),Sn over Ni
 Contact Clip(4 finger):BeCu(C17200),Au or Sn over Ni
 Insulator Material:PPS+30%G.F(UL94V-0)

Ordering Information

3522-282 XX R XX 096 X 1

No. of Pin
2~40PIN

Contact Plating
S0=Gold Flash/Tin
S3=10u"Gold/Tin
S4=15u"Gold/Tin
S5=30u"Gold/Tin
SN=Tin

Packing
A=Tray
T=Tube

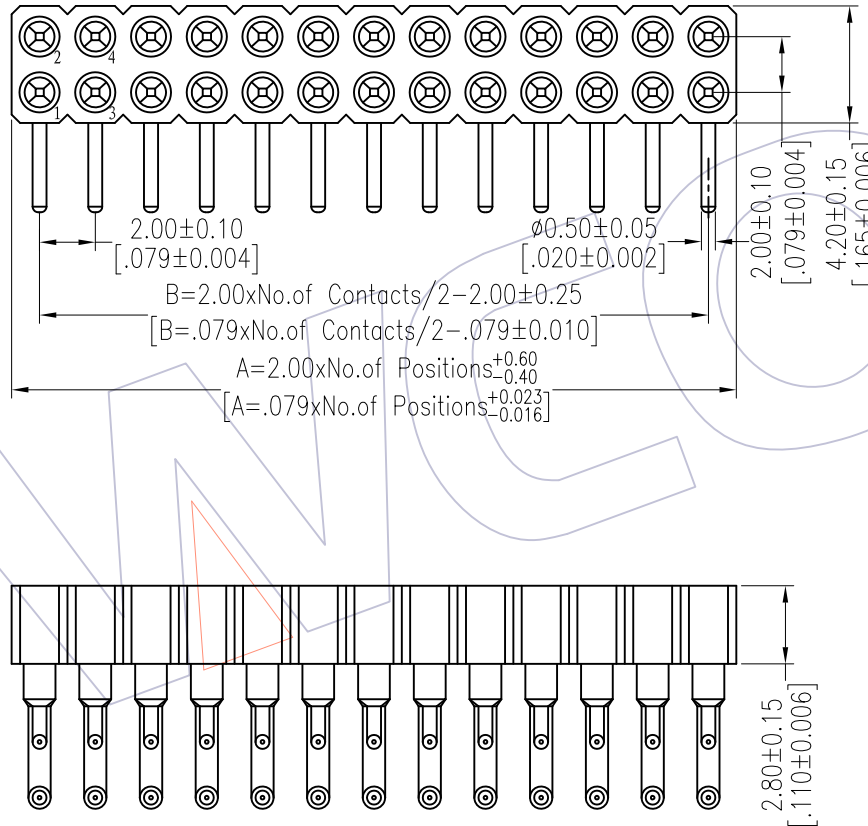

Recommended P.C.B Layout(Top Side)
 (PCB BOARD TOLERANCE ± 0.05)

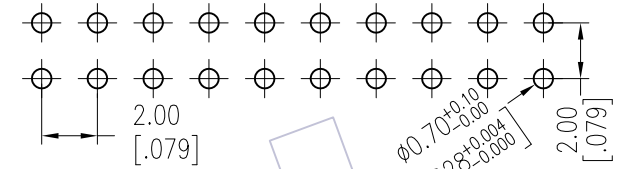

NO.of PIN	DIM A
40PIN	2.0*NO.of Positions+1.00±0.40
<40PIN	2.0*NO.of Positions ^{+0.60} _{-0.40}

Item	Pitch	Mating
Standard	2.00	3512
Alternate		

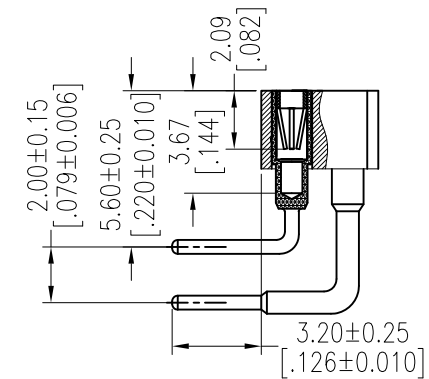

REV	DATE	MODIFICATION DESCRIPTION	CHANGE	OPERATION		DRAW	DATE	SCALE	FIT	PART NO.
				X.X	±0.40					
A1	2013/05/17	Modify drawing	-----	X.XX	±0.25	Wang	2013/05/17	UNIT	mm	3522-282XXRX096X1
A0	2012/10/17	NEW	-----	X.XXX	±0.15	CHECK	DATE	SIZE	A4	TITLE: 2.00mm MACHINED FEMALE HEADER DUAL ROW 90° H=2.80 L=9.6
				Angle	± 3°	APPROVE	DATE	SHEET	1/1	Customer NO.
				DIM	TOL			PROJ.	☉	