

HSF

TECHNICAL SPECS:

Current Rating: 1.0AMP
 Contact Resistance: 10mΩ Max
 Dielectric Strength: Min 1000Vrms
 Mechanical Life: Min 100 cycles
 Mating Pin: $\varnothing 0.40$ to $\varnothing 0.56$ mm
 Forces: (polished steel gauge $\varnothing 0.43$ mm)
 Insertion: 200g Max/Pin, Withdrawal: 60g Min/Pin
 Operation Temperature: -40°C to $+105^{\circ}\text{C}$

Sleeve: Brass CuZn36Pb3(C36000), Sn over Ni
 Contact Clip(4 finger): BeCu(C17200), Au or Sn over Ni
 Insulator Material: PPS+30%G.F(UL94V-0)
 24P~32P Insulators with center one bar
 36P~48P Insulators with center two bar

Ordering Information

7110-302 XX M XX 074 X 1

Row of Pitch 2=15.24mm	No. of Pin See tab	Contact Plating S0=Gold Flash/Tin S3=10u"Gold/Tin S4=15u"Gold/Tin S5=30u"Gold/Tin SN=Tin	Packing T=Tube R=Tape&Reel
---------------------------	-----------------------	---	----------------------------------

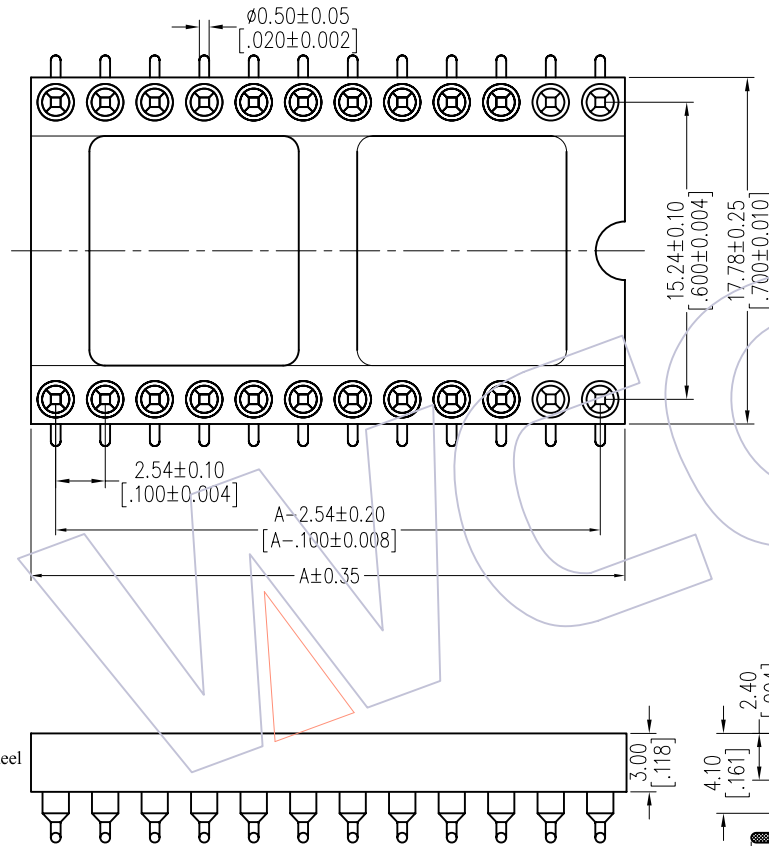

Recommended P.C.B Layout(Top Side)
 (PCB BOARD TOLERANCE ± 0.05)

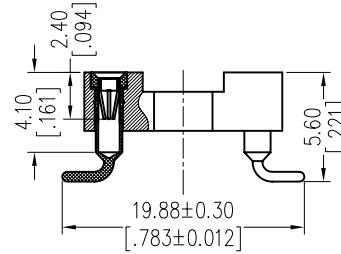
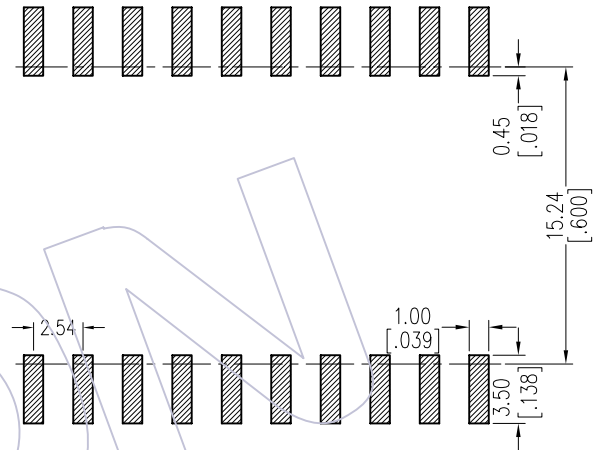

Dimensional & Ordering Information

NO. of Poles	Part No.	Dim
		A
24	7110-30224MXX074X1	30.48
28	7110-30228MXX074X1	35.56
32	7110-30232MXX074X1	40.64
36	7110-30236MXX074X1	45.72
40	7110-30240MXX074X1	50.80
42	7110-30242MXX074X1	53.34
48	7110-30248MXX074X1	60.96

REV	DATE	MODIFICATION DESCRIPTION	CHANGE	OPERATION	DRAW	DATE	SCALE	FIT	PART NO.
				X.X ±0.40	JYHuang	2012/11/02	UNIT	mm	7110-302XXMX074X1
				X.XX ±0.25	CHECK	DATE	SIZE	A4	
				X.XXX ±0.15	APPROVE	DATE	SHEET	1/1	
				Angle ± 3°			PROJ.	Customer NO.	
				DIM TOL					

TITLE:
 2.54mm IC SOCKET SMT H=3.0 L=7.43
 Row of Pitch 15.24mm