

# HSF

Recommended P.C.B Layout(Top Side)  
(PCB BOARD TOLERANCE±0.05)

NOTES:  
Current Rating: 3.0AMP  
Voltage Rating: 250V AC,DC  
Contact Resistance: 20mΩ max  
Withstand Voltage: 800V AC/DC  
Insulation Resistance: 1000MΩ min  
Operation Temperature: -25°C to +85°C

Contact Material: Brass  
Contact plating: Au Or Sn Over Ni  
Insulator Material: PA66 Or PA46 UL94V-0

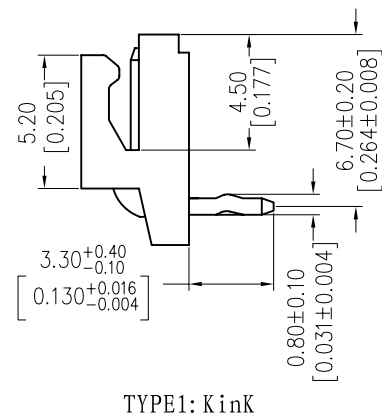
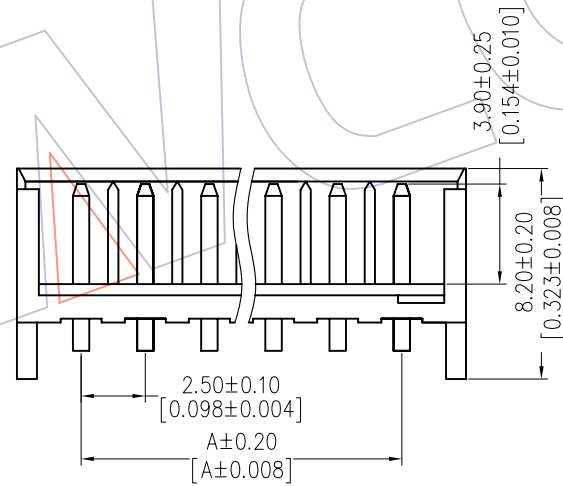
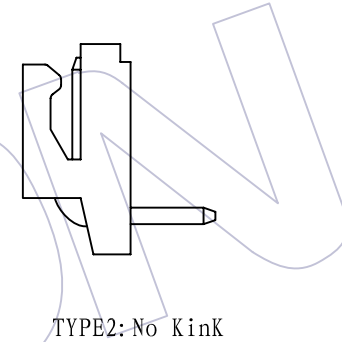
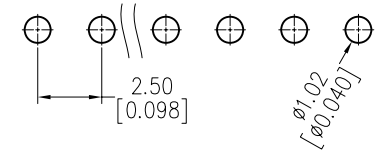
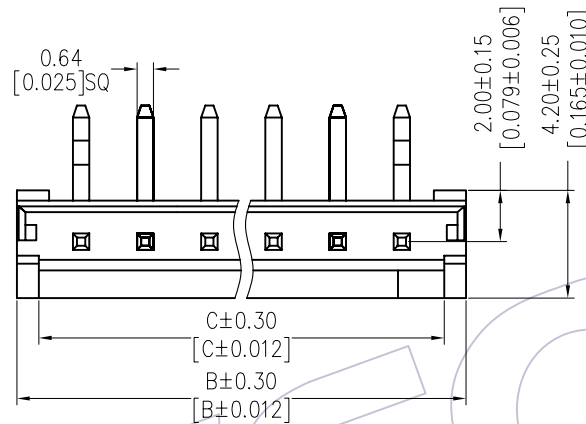

## Ordering Information

**WF2504 -WR XX X 0 X**

Insulator Material: H=PA46, Blank=PA66  
No. of pins: 02-16P, 20P  
Contact Plating: S0=Gold Flash/Tin, S3=10u"Gold/Tin, S4=15u"Gold/Tin, S5=30u"Gold/Tin, G0=Gold Flash, G3=10u"Gold, G4=15u"Gold, G5=30u"Gold, Blank=Tin  
Color: B=Black, E=Beige, W=White, T=Natural  
Series No.: 1=Type 1, 2=Type 2  
Packing: 0=PE Bag, T=Tube, P=Tube+CAP

## Specification & Ordering Information:

Circuit	Part No.	Dimension			Q'ty /Bag
		A	B	C	
02	WF2504-WR02X0X	2.50	7.5	5.6	1,000
03	WF2504-WR03X0X	5.00	10.0	8.1	1,000
04	WF2504-WR04X0X	7.50	12.5	10.6	1,000
05	WF2504-WR05X0X	10.00	15.0	13.1	1,000
06	WF2504-WR06X0X	12.50	17.5	15.6	1,000
07	WF2504-WR07X0X	15.00	20.0	18.1	1,000
08	WF2504-WR08X0X	17.50	22.5	20.6	1,000
09	WF2504-WR09X0X	20.00	25.0	23.1	1,000
10	WF2504-WR10X0X	22.50	27.5	25.6	1,000
11	WF2504-WR11X0X	25.00	30.0	28.1	1,000
12	WF2504-WR12X0X	27.50	32.5	30.6	1,000
13	WF2504-WR13X0X	30.00	35.0	33.1	1,000
14	WF2504-WR14X0X	32.50	37.5	35.6	1,000
15	WF2504-WR15X0X	35.00	40.0	38.1	1,000
16	WF2504-WR15X0X	37.50	42.5	40.6	1,000
20	WF2504-WR15X0X	47.50	52.5	50.6	1,000

REV	DATE	MODIFICATION DESCRIPTION	CHANGE	OPERATION		DRAW	DATE	SCALE	FIT	PART NO.
				X.X	±0.40					
				X.XX	±0.25	JYHuang	2012/09/06	UNIT	mm inch	SEE TAB
				X.XXX	±0.15	CHECK	DATE	SIZE	A4	TITLE: EH PH2.50 WAFER 90° DIP
AO	2012/09/06	NEW		Angle	± 3'	APPROVE	DATE	SHEET	1/1	Customer NO.
				DIM	TOL			PROJ.		