

HSF

NOTES:
 Current Rating: 3.0AMP
 Voltage Rating: 250V AC,DC
 Contact Resistance: 20mΩ max
 Withstand Voltage: 800V AC/Minute
 Insulation Resistance: 1000MΩ min
 Operation Temperature: -25°C to +85°C

Contact Material: Brass
 Contact plating: Au Or Sn Over Ni
 Insulator Material: PA66 UL94V-0

Recommended P.C.B Layout(Top Side)
 (PCB BOARD TOLERANCE ±0.05)

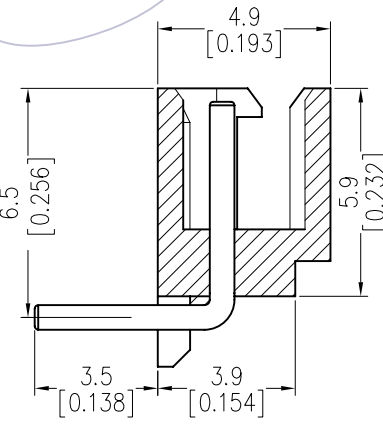
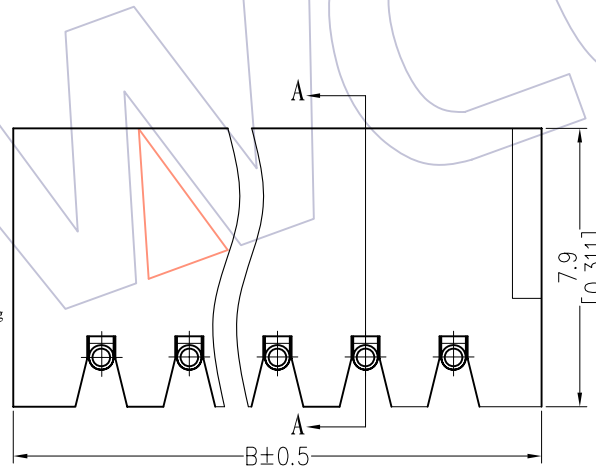
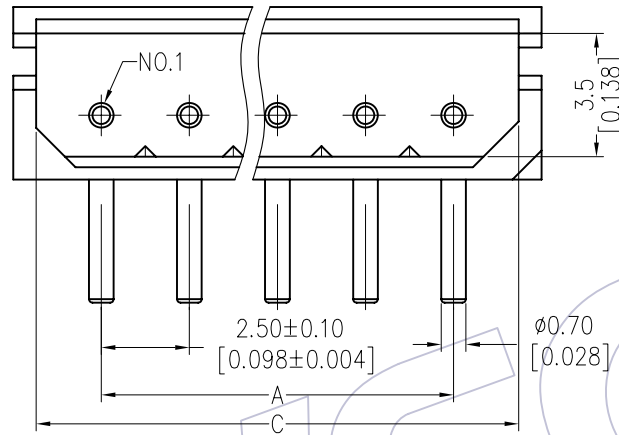
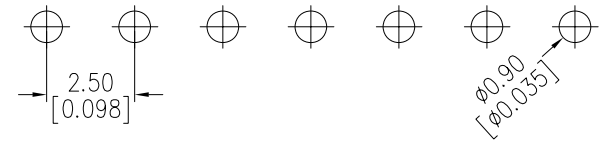

Specification & Ordering Information:

Circuit	Part No.	Dimension		
		A	B	C
02	WF2502-WR02X01	2.5	7.4	6.0
03	WF2502-WR03X01	5.0	9.9	8.5
04	WF2502-WR04X01	7.5	12.4	11.0
05	WF2502-WR05X01	10.0	14.9	13.5
06	WF2502-WR06X01	12.5	17.4	16.0
07	WF2502-WR07X01	15.0	19.9	18.5
08	WF2502-WR08X01	17.5	22.4	21.0
09	WF2502-WR09X01	20.0	24.9	23.5
10	WF2502-WR10X01	22.5	27.4	26.0
11	WF2502-WR11X01	25.0	29.9	28.5
12	WF2502-WR12X01	27.5	32.4	31.0
13	WF2502-WR13X01	30.0	34.9	33.5
14	WF2502-WR14X01	32.5	37.4	36.0
15	WF2502-WR15X01	35.0	39.9	38.5
16	WF2502-WR16X01	37.5	42.4	41.0
17	WF2502-WR17X01	40.0	44.9	43.5
18	WF2502-WR18X01	42.5	47.4	46.0
19	WF2502-WR19X01	45.0	49.9	48.5
20	WF2502-WR20X01	47.5	52.4	51.0

Ordering Information

WF2502 - WR **XX** **X** **0** **1**

- No. of pins: 02P-20P
- Contact Plating: S0=Gold Flash/Tin, S3=10u"Gold/Tin, S4=15u"Gold/Tin, S5=30u"Gold/Tin, G0=Gold Flash, G3=10u"Gold, G4=15u"Gold, G5=30u"Gold, Blank=Tin
- Color: B=Black, T=Natural, W=White, E=Beige
- Packing: 0=PE Bag, T=Tube

REV	DATE	MODIFICATION DESCRIPTION	CHANGE	OPERATION	DRAW	DATE	SCALE	FIT	PART NO.
AO	2012/08/28	NEW		X.X ±0.40	JYHuang	2012/08/28	UNIT	mm	SEE TAB
				X.XX ±0.25	CHECK	DATE	SIZE	A4	TITLE:
				X.XXX ±0.15	APPROVE	DATE	SHEET	1/1	2.50 WAFER 90° DIP
				Angle ± 3°			PROJ.	Customer NO.	
				DIM TOL					

WCON