

# HSF

**NOTES:**

Current Rating: 5.0AMP  
 Contact Resistance: 10mΩ Max  
 Withstand Voltage: 1000V AC/Minute  
 Insulation Resistance: 1000MΩ Min  
 Operation Temperature: -25°C to +85°C

Contact Material: Brass  
 Contact plating: Au or Sn over Ni  
 Insulator Material: Polyester (UL94V-0)  
 Standard: LCP

## Ordering Information

**WF3001-4WR 09 B X 1**

Terminal shape:	NO.of Pins Per	Packing:
WR:Wafer 90° DIP	Row:09Pin	T=Tube
		A=Tray
		R=Tape&Reel

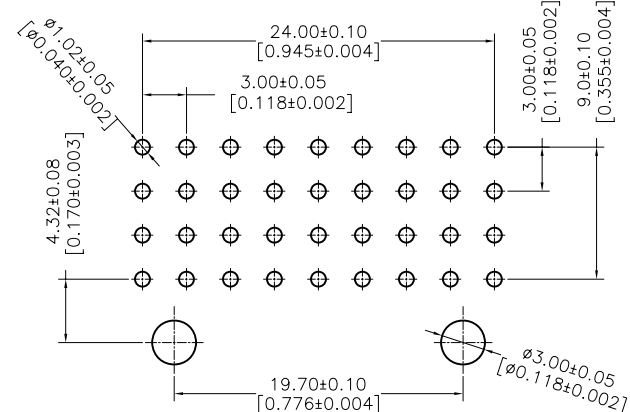
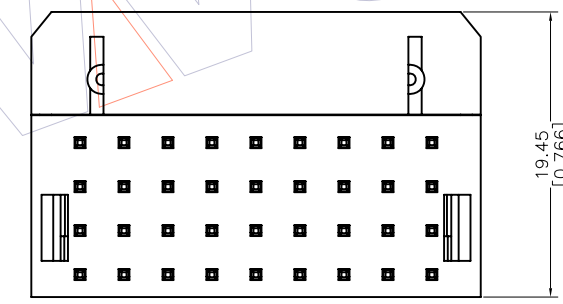
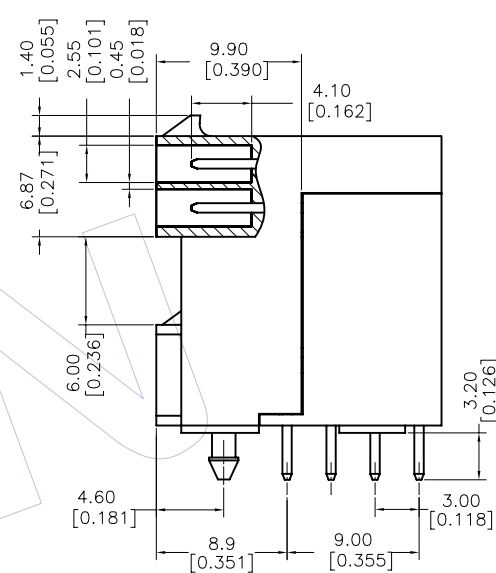
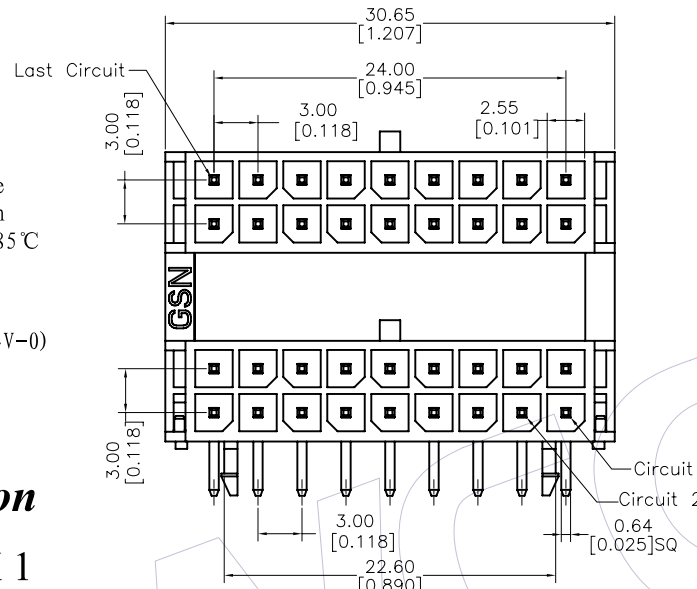

Recommended P.C.B Layout(Top Side)

			OPERATION		DRAW	DATE	SCALE	1:1	PART NO.	<h1>WCON</h1>	
			X.X	±0.40	Rikey	2012.03.07	UNIT	mm	WF3001-4WR09BX1		
A1	2012.05.15	Added Mark	YSH	X.XX	±0.25	CHECK	DATE	SIZE	A4		TITLE:
A0	2012.03.07	NEW	-	X.XXX	±0.15	APPROVE	DATE	SHEET	1/1		3.0mm Wafer 四排 90°DIP 带叉柱
REV	DATE	MODIFICATION DESCRIPTION	CHANGE	Angle	± 3'			PROJ.	Customer NO.		